

Multi-Function Sensor

The Prolojik PS432C BESA conduit box mount mini DALI addressable multifunction sensor delivers high accuracy measurement in a discreet form factor.

Prolojik PS432 sensors have been designed to complement the Prolojik range of lighting control modules and DALI controllers and are available in a range of lens types and finishes. All sensors only occupy a single DALI address.



Key Features

- Passive infra-red sensor
- Light level sensor
- Temperature sensor
- Active infra-red receiver



Conduit box not included – can be ordered separately: EN400C

Prolojik | Perspective House | 7 Cliveden Office Village | Lancaster Road
High Wycombe | Buckinghamshire HP12 3YZ | United Kingdom
+44 (0)1494 515100 | info@prolojik.com | prolojik.com

Multi-Function Sensor

Specification

Occupancy
Sensor type: Passive Infra-Red, Quad Element
Field of view: 360°
Coverage: 2.5 x height of ceiling (7 meters max)

Light Level
Sensor type: Photo-diode
Accuracy: +/-5% across range
Field of view: 360°

Temperature
Sensor range: 0 to +56°C

Active Infra-red receiver
Used for DALI addressing
For dimming & scene setting

Environment
Storage
Temperature: -10°C to +60°C
Humidity: 0% - 90% non-condensing

In Use
Temperature: 0 to +56°C
Humidity: 10% - 90% non-condensing

Conformity & Standards
EMC immunity EN50082-1
EMC emissions EN50081-1
Housing material flame-proof ABS
DALI & NEMA compliant
IEC Standard 62386-102
NEMA Standard NS243-2004
Supports DALI 2 & 3 byte protocol
ARCOM MasterSpec 2013 Classification 29 09 23

Dimensions
21.5mm deep x 65.0 diameter
Face 65.0mm
Weight 22g

Commissioning aids
Occupancy walk test via LED - single flash IR reception from PC100/PC310 - triple flash
Reboot - Rapid Flash

Installation
Fits standard BESA box (BESA box not included)
Do NOT fit within one meter of forced air heating or ventilation, or other sources of heat or draughts
Do NOT fit so that direct sunlight or artificial light passes straight into the unit
Do not obscure sensor by fixtures and fittings
Do NOT fit on a moving or vibrating surface
Ensure adequate space is provided behind sensor for through cabling

PS432C Connector
2 x DA push in spring connections

Power Consumption
4mA nominal consumption at 15V DALI bus voltage

Technical Data

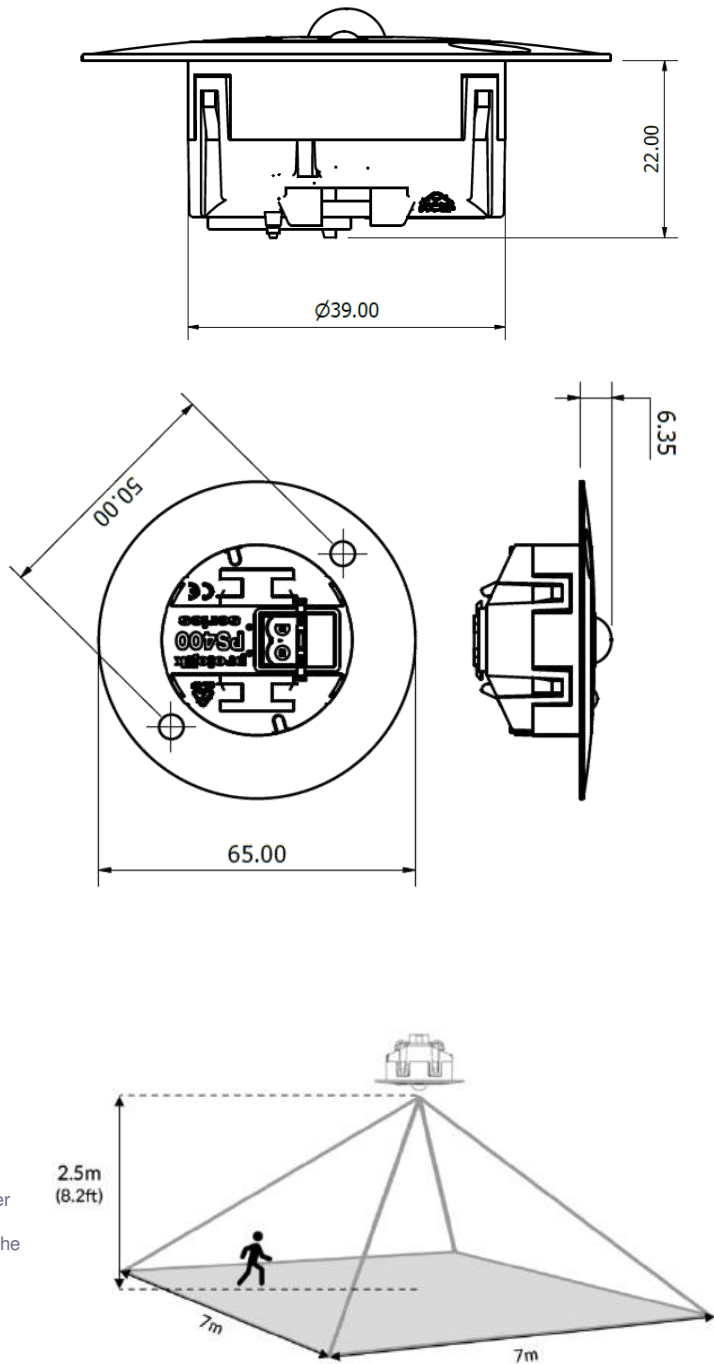

Prolojik | Perspective House | 7 Cliveden Office Village | Lancaster Road
High Wycombe | Buckinghamshire HP12 3YZ | United Kingdom
+44 (0)1494 515100 | info@prolojik.com | prolojik.com